



FRANCE CRUISES



PANACHE

12 Passengers / Alsace / Champagne / Paris/Ile de France /

Constructed in 1959 as a Dutch commercial freight barge

Converted into hotel barge in 1998

Measures 129 ft. long by 16 ft. wide

Six (6) onboard cabin accommodations

Twelve (12) passenger capacity

Central Heating and Air Conditioning

Formerly "Marjorie 2," the 12-passenger **Panache** is of Dutch design, traditionally furnished in an old ship style with brass and mahogany. She boasts a spacious saloon and dining room, and sun deck with a heated pool, aiming to provide a comfortable and charming ambience for all who step aboard her timeless beauty.

PERSONNEL

Five (5) crew members who speak both English and French (some may speak other languages, as well).

PUBLIC ROOMS

- **Salon**
- **Dining Room**
- **Sun Deck**

ONBOARD LEISURE AND ENTERTAINMENT

HI FI system with CD player • Twelve (12) touring bikes • Upright piano • Satellite TV with DVD player & video library • Board games • Small library of books • Heated spa pool • WiFi internet access • Binoculars for bird-watching • Telescope

MOBILITY RESTRICTIONS

Panache has **no wheelchair access**. There are several decks with steps leading to the Salon and Cabins, as well as narrow passageways which may be difficult to navigate for those with extremely limited mobility.

DECK PLAN

The **Panache** has truly set the standard of excellence in European canal barging. The sleek vessel welcomes its guests with warm interiors, elegant furnishings, spacious public areas and comfortable staterooms.

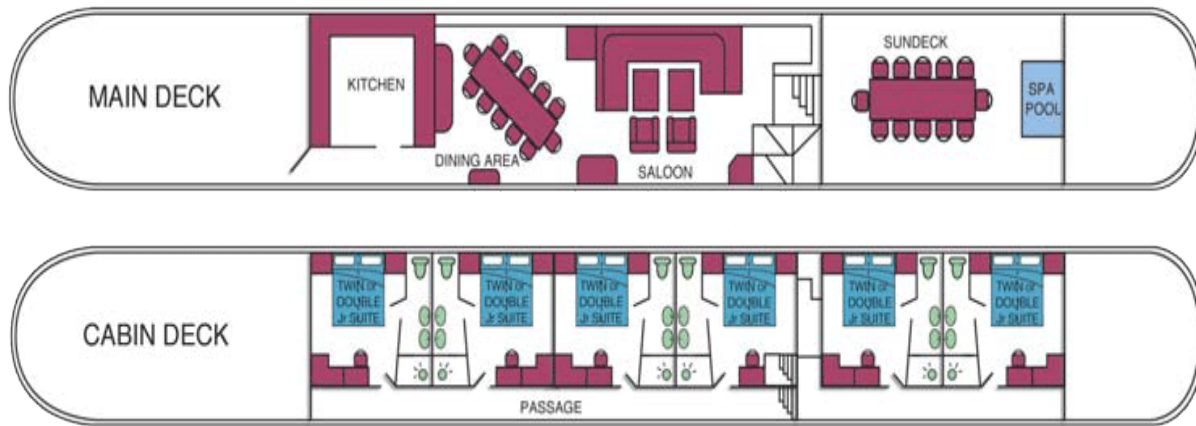

CABINS

Panache features six (6) junior suites with a choice of 2 single beds or a double bed, fully carpeted and all featuring an en-suite marble bathroom. Each cabin offers fitted wardrobes, two (2) bedside tables with a reading lamp, a writing desk with a chair and TV/DVD mounted on the wall. There are 2 wide-curtained windows (3ft 8 in x 20 in) and cooling/heating units in each cabin which can be thermostatically controlled. There are also several French 2 pin plug sockets available for electrical appliances. Guests are welcome to use the white bathrobes which are located in the wardrobes. Life jackets under each bed are available for emergencies. Cabin 1 and 2 are 6 steps down from the main Saloon deck and the other 4 cabins are a further 4 steps down on the lower deck.

CABIN SIZE

All cabins are fully furnished, equally comfortable, and adequately sized. The size listed below for each cabin includes bathroom area.

- **Ravel** - Approx. 150 sq. ft.
- **Debussy**- Approx. 150 sq. ft.
- **Berloiz** - Approx. 155 sq. ft.
- **Bizet**- Approx. 150 sq. ft.
- **Faure**- Approx. 150 sq. ft.
- **Dukas**- Approx. 150 sq. ft.



BEDDING CONFIGURATION & SIZE

All cabins can be configured either as two (2) twin beds or one (1) queen bed. When the cabins are in twin configuration, the beds will be parallel to each other with a space in between.

BATHROOMS

All cabins have fully private en suite bath facilities, complete with shower cubicle, toilet and basin. They are well-stocked with towels and bath products.

AMENITIES

Individually controlled Central Heating and Air Conditioning • Hairdryer • Bathrobes • Slippers • Built-in Closet • Electricity (220V, French two pin plugs)

SALON/DINING ROOM

The **Salon/Dining Room** is a tastefully decorated and well-designed interior living space created for luxury and spaciousness. The six (6) large panoramic windows on each side allows for pouring natural sunlight and picturesque views of the passing landscape. In the lounge, guests can relax on the large, U-shaped sofa, or watch TV, listen to music, read a book from the library or enjoy refreshing beverages from the open bar.



The **Salon/Dining room** provides a spacious 600 sq. ft. and features:

- 2 Sofas & coffee tables
- 2 Armchairs
- Upright piano
- Game table

ON DECK

The sundeck on board **Panache** is an open-air gathering place that boasts a heated spa pool for its guests to enjoy under the warm sunlight. The deck also hosts an "Al-fresco" dining table with twelve (12) seats.

OFF BOAT

Passengers are welcome to walk or cycle using the onboard bicycles as often as they like. Most people choose to disembark the barge at a lock to visit local villages, then return to the canal and meet the barge further along (the barge travels slowly; therefore, this is not a problem). An air-conditioned minibus is also available for transfers and on shore excursions.

ITINERARY

The season begins with Spring "Tulip Cruises" in **Holland** where you will experience a full kaleidoscope of colors as **Panache** cruises through the tulip fields. There will also be visits to the spectacular Keukenhof Gardens, the world famous porcelain pottery at Delft, the cheese centre of Gouda and famed the Floriade World Horticultural Expo, a spectacle of all things botany only held every 10 years. The summer brings **Panache** to the beautiful waterways of France. Discover **Alsace-Lorraine**, a region in Eastern France with a unique mix of French and German cultures, Baroque and Romanesque architecture, storybook hamlets and wonderful white wines.

Itinerary Highlights:

Alsace-Lorraine Cruise - Take a walking tour of the city of **Nancy**, home of the Art Nouveau movement and a visit to Strasbourg's **Gothic Cathedral** on this glorious cruise between Bruges and Cambrai.

Champagne Cruise - Explore the magnificent **Chateau of Vaux-le-Vicomte** and sample **Moet & Chandon** champagne on this splendid cruise which includes some of the greatest sites in France.

Holland Cruise - Tour the famous **Keukenhof Gardens** with the largest display of flowers in the world and the once-a-decade **Floriade 2012 Expo**.

Two Week Cruise - A 13-day journey from Paris to Bruges allows guests to take in the best of both countries with sites like the village of **Auvers sur l'Oise**, where Vincent van Gogh spent his last days.

Paris & Northern Cruise - See some of the greatest sites in France including **Monet's gardens** at Giverny and **Compiègne's** three famous museums.

FOOD & WINE

Each day, the chef combines fresh ingredients drawn from local markets to create the most incredible cuisine you have ever experienced. The menus you will experience aboard will always be unique, and tailored to your specific needs. The following menu selections are typical, but cuisine aboard will be different - and is sure to surprise and delight you!

Regional specialties

Medallions of Veal with a Girolles and Truffle Sauce, Breast of Duck with a Passion Fruit Glace, Crepes Suzette with Homemade Vanilla Ice Cream

Wine cellar

Riesling Grand Cru, Chassagne-Montrachet, Chablis Premier Cru Pouilly Fuisse, Gewurztraminer

Cheese board

Munster, Brie de Meaux, Fourme d'Ambert, Chaource