



FRANCE CRUISES



NYMPHEA

6 Passengers / Loire Valley & Chateaux Country

Constructed in 1921 as a freight barge

Converted into a hotel barge in 1985

Measures 81 ft. long by 14 ft. wide

Three (3) onboard cabin accommodations

Onboard climate control

The 6-passenger **Nymphéa** is a classic Dutch design with shallow draft and is ideal for navigating the incredibly beautiful yet somewhat sandy reaches of the river Cher in the Loire valley. To date, the **Nymphéa** is the only cruising barge navigating this fabled Chateaux Country.

PERSONNEL

Three (3) crew members consisting of Chef, Housekeeper, and Captain. Generally British, this crew speaks both English and French (some may speak other languages, as well).

PUBLIC ROOMS

- **Salon/Dining Room**
- **Upper Salon**
- **Sun Deck**

ONBOARD LEISURE AND ENTERTAINMENT

HI FI system with CD player • Six (6) mountain bikes (21 speed) • Board games • Small library of books • Binoculars for birdwatching

MOBILITY RESTRICTIONS

Nymphéa has a gangway from the bank of the river with a handrail and six (6) wide steps. The top deck has rails all the way around. Stairways have one (1) handrail. There are seven (7) steps from the main deck down to the Chenonceau stateroom and another set of seven (7) steps from the main deck down to the salon/dining area. There are no steps from the salon to the other cabins, and the crew will assist in any way they can. **If you would like to hire a wheelchair so that it is available on your arrival**, please specify at the time of booking. The nominal hire charge should be paid directly to the Captain on arrival.

DECK PLAN

The well-planned accommodation of Nymphéa offers a choice of three air-conditioned twin/double staterooms with full en-suite facilities.

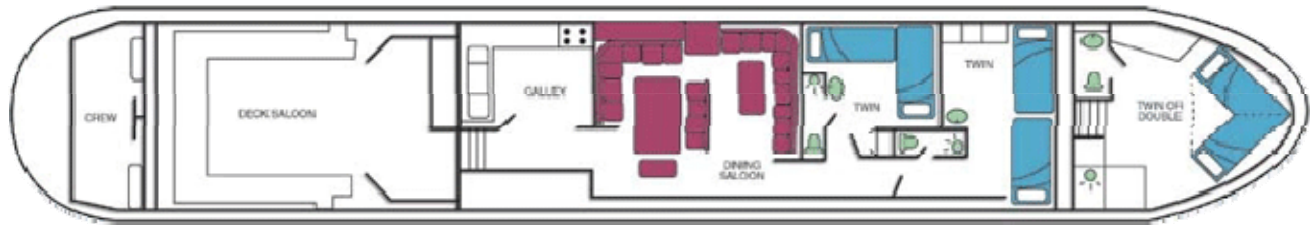

CABINS

There are three (3) staterooms on board **Nymphéa**, named **Chenonceau**, **Chambord**, and **Cheverny**.

CABIN SIZE

All cabins are very similar in size and are equally comfortable. The size listed below for each cabin includes bathroom area.

- **Chenonceau** - Approx. 91 sq. ft.
- **Chambord** - Approx. 75 sq. ft.
- **Cheverny** - Approx. 65 sq. ft.

BEDDING CONFIGURATION & SIZE

Chenonceau can be configured as a twin or a double while **Chambord** and **Cheverny** can be configured as twin only. **Chambord's** beds will be foot to foot while **Cheverny's** will be in an "L" shape.

The bed sizes are:

- Twin - 2 ft. 6 in. X 6 ft.
- Double - 6 ft. X 5 ft.



BATHROOMS

All bathrooms have shower, toilet, and wash basin, and come stocked with towels, washing gel, hand soap, and shampoo.

AMENITIES

Climate Control • Hairdryer • Built-in Closets • Electricity (220V, French two pin plugs)



SALON/DINING ROOM

The **Salon/Dining Room** provides a comfortable 200 sq. ft. and features:

- Built-in seating
- Coffee table
- Fully-stocked bar with cupboard & refrigerator
- Mahogany dining table seating seven (7) people

The **Salon/Dining Room** is dressed in mahogany paneling and brass light fittings, all covered by a hardwood ceiling. The floor is also of hardwood and the stained-glass windows create a warm environment. This salon is on the same level as the cabins.

UPPER SALON

The **Upper Salon** is a modest 48 sq. ft. and has comfortable seating and larger windows for greater viewing capacity.

ON DECK

The **Sun Deck** is a spacious 200 sq. ft. open-air gathering area with beautiful deck furniture which consists of:

- 6 reclining chairs
- 1 parasol

OFF BOAT

Passengers are welcome to walk or cycle using the onboard bicycles as often as they like. Most People choose to disembark the barge at a lock to visit local villages, then return to the canal and meet the barge further along (the barge travels slowly; therefore, this is not a problem). An air-conditioned, 7-seater VW Sharan minibus is also available for excursions by vehicle.

ITINERARY

The spectacular Loire Valley and its main tributary, the River Cher, have carried cargo and passengers for over 2000 years, since pre-Roman times. The Valley of the Kings is a timeless region of spectacular beauty and grace. The proximity of such a wealth of gorgeous architecture makes Nympha's cruise a unique travel experience.

Itinerary Highlights:

Cruise under the famed **Château de Chenonceau**

Visit a **Troglodyte cave dwelling** and see the silkworm nursery

Excursion to the **Château D'Amboise**

Private wine tastings at **Montrichard, Civray** or **Domaine de Fontenay**

Chateau visits to **Valencay** or **Blois**

Experience the **colorful street markets**

FOOD & WINE

Cuisine on board **Nympha** is French. All meals are composed of fresh ingredients and typically feature a different selection of regional cheeses and wines daily. Non-alcoholic beverages, regular or decaffeinated tea & coffee, and whole or low-fat milk are offered with all meals. There are no assigned seats for meals in the dining room and dress is casual. The Captain's Dinner on the last night of the cruise requires slightly formal attire.

2010 SCHEDULE & PRICING

Date	Direction	Season	Date	Direction	Season
June 27, 2010	Nitray - Azay	Value	August 29, 2010	Azay - Nitray	Regular
July 4, 2010	Azay - Nitray	Value	September 5, 2010	Nitray - Azay	Value
July 11, 2010	Nitray - Azay	Value	September 12, 2010	Azay - Nitray	Value
July 18, 2010	Azay - Nitray	Value	September 19, 2010	Nitray - Azay	Value
July 25, 2010	Nitray - Azay	Value	September 26, 2010	Azay - Nitray	Value
August 1, 2010	Azay - Nitray	Value	October 3, 2010	Nitray - Azay	Value
August 8, 2010	Nitray - Azay	Value	October 10, 2010	Azay - Nitray	Value
August 15, 2010	Azay - Nitray	Regular	October 17, 2010	Nitray - Azay	Regular
August 22, 2010	Nitray - Azay	Regular	October 24, 2010	Azay - Nitray	Regular

Individual Cabin Bookings	Regular Weeks
Per Person (2 sharing)	\$3,800
Single Supplement	\$1,700
Full Boat Private Charter	Regular Weeks
For 6 guests	\$21,800
For 5 guests	\$20,600
For 4 guests	\$19,400
For 2 guests (Honeymoon)	\$15,800