



## FRANCE CRUISES



### **L'IMPRESSIONNISTE** *13 Passengers / Burgundy*

*Constructed in 1960 as a general cargo carrier  
Converted into a hotel barge in 1996  
Measures 126 ft. long by 16.5 ft. wide  
Seven (7) onboard cabin accommodations  
Onboard climate control*

The 13 passenger **L'Impressionniste** began life as a cargo barge in Holland before undergoing a complete transformation into the powerful canal and river cruiser she is today. **L'Impressionniste** cruise route covers some fine rural cruising, with plenty of opportunity to cycle and stroll along the tow-path and wander into nearby villages.

### **PERSONNEL**

Five (5) crew members consisting of Tour Guide/Deckhand, Chef, Housekeeper, Stewardess, and Captain. Generally British, this crew of five speaks both English and French (some may speak other languages, as well).

### **PUBLIC ROOMS**

- **Salon/Dining Room**
- **Sun Deck**

### **ONBOARD LEISURE AND ENTERTAINMENT**

Heated Jacuzzi built for six (6) people • HI FI system with CD player • Boules • Ten (10) mountain bikes (14 speed) • Board games • Binoculars for birdwatching

### **MOBILITY RESTRICTIONS**

L'Impressionniste has a gangplank from the bank to the deck with two (2) handrails and two (2) wide steps from the deck to the salon. There are twelve (12) steps from the salon to the cabins. These steps have a handrail and are wide enough for one (1) person to walk beside another for assistance. **If you would like to hire a wheelchair so that it is available on your arrival, please specify at the time of booking. The nominal hire charge should be paid directly to the Captain on arrival. Please note, however, that wheelchair access to monuments, tours, and the barge is very limited.**

### **DECK PLAN**

The well-planned accommodation of the L'Impressionniste offers a choice of seven air-conditioned twin/double staterooms with full en-suite facilities.

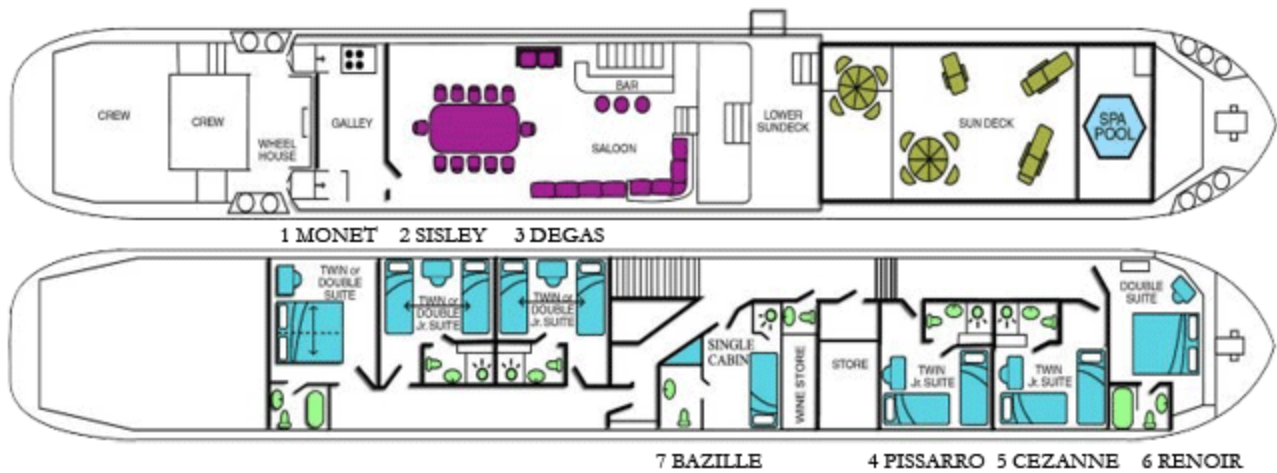

## CABINS

There are six (6) suites and one (1) single cabin on board **L'Impressionniste**, named **Monet**, **Renoir**, **Pissarro**, **Cezanne**, **Sisley**, **Degas**, and **Bazille** respectively.

## CABIN SIZE

All cabins are very similar in size and are equally comfortable. The size listed below for each cabin includes bathroom area.

- **Monet** (Stern Suite) - Approx. 170 sq. ft.
- **Renoir** (Bow Suite) - Approx. 155 sq. ft.
- **Pissarro** (Stern Junior Suite) - Approx. 135 sq. ft.
- **Cezanne** (Stern Junior Suite) - Approx. 135 sq. ft.
- **Sisley** (Bow Junior Suite) - Approx. 125 sq. ft.
- **Degas** (Bow Junior Suite) - Approx. 125 sq. ft.
- **Bazille** - Approx. 90 sq. ft.

Each stateroom has portholes or windows for viewing the passing landscapes or letting in fresh air. The number of portholes available varies from stateroom to stateroom:

- **Renoir** - 4 large square windows, 2 of which open
- **Monet** - 4 portholes, 2 of which open
- **Pissarro** - 2 opening windows
- **Cezanne** - 2 opening windows
- **Sisley** - 3 portholes, 2 of which open
- **Degas** - 3 portholes, 2 of which open
- **Bazille** - 2 opening portholes

## BEDDING CONFIGURATION & SIZE

Each stateroom has specific bedding configurations as outlined below:

- **Monet** - twin or double
- **Renoir** - double
- **Pissarro** - twin
- **Cezanne** - twin
- **Sisley** - twin or double
- **Degas** - twin or double
- **Bazille** - single



When the suites are in twin bed configuration, the beds are parallel with a gap between them. Bed sizes are:

- Twin - 3 ft. X 6 ft.
- Double - 6 ft. X 6 ft. (**Renoir's** double measures 6 ft. 3 in. X 6 ft.)

## BATHROOMS

**Monet** and **Renoir** have full-length baths and a shower attached to the wall with shower curtain. They have the most floor space. The remaining staterooms have showers in a shower cubicle. All cabins have marble tiled floors and walls and a household flush toilet and basin. All bathrooms are stocked with towels, washing gel, hand soap, and shampoo.

## AMENITIES

Climate Control • Hairdryer • Built-in Closets • Dehumidifier • Electricity (220V, French two pin plugs)



## SALON/DINING ROOM

The **Salon/Dining Room** provides a comfortable 325 sq. ft. and features:

- Built-in sofa area
- Coffee table
- Fully-stocked oak bar
- Mahogany dining table with seating for thirteen (13) people

## ON DECK

There are two (2) **Sun Decks** on board **L'Impressionniste**, one of which is shaded. The shaded deck is approximately 118 sq. ft. while the other is a spacious 437 sq. ft. open-air gathering

area. The **Sun Deck** is perfect for sun bathing and enjoying the beautiful scenery as you slowly wind through the canals of France. The beautiful deck furniture consists of:

- 2 steamer chairs
- 13 reclining chairs
- 1 large table
- 2 small tables

## OFF BOAT

Passengers are welcome to walk or cycle using the onboard bicycles as often as they like. Most People choose to disembark the barge at a lock to visit local villages, then return to the canal and meet the barge further along (the barge travels slowly; therefore, this is not a problem). An air-conditioned, 9-seater (including driver) VW Caravelle minibus and an air-conditioned, 6-seater VW Sharan minibus are also available for excursions by vehicle.

## ITINERARY

**L'Impressionniste** cruises the beautiful Southern Burgundy region, on the Burgundy Canal between Dijon and Escommes, one of the best areas for high quality wine visits and tastings. The itinerary includes the must see tours of Dijon, Beaune, Nuit Saint Georges and Chateauneuf-en-Auxois...all this and more aboard the 13-passenger **L'Impressionniste**.

### Itinerary Highlights:

**Dijon**, the capital and Burgundy and the the wine center of **Beaune**

**Clos de Vougeot**, headquarters of the esteemed Chevaliers du Tastevin

Private wine tasting at a family run Domaine in the heart of **Nuits-St-Georges** on the route des Grands Crus

13th century **Chateau de Commarin** and the 12th century **Abbaye de la Bussiere** including luncheon in the Michelin starred restaurant

## FOOD & WINE

Cuisine on board **L'Impressionniste** is French. All meals are composed of fresh ingredients and typically feature a different selection of regional cheeses and wines daily. Non-alcoholic beverages, regular or decaffeinated tea & coffee, and whole or low-fat milk are offered with all meals. There are no assigned seats for meals in the dining room and dress is casual. The Captain's Dinner on the last night of the cruise requires slightly formal attire.

## 2010 SCHEDULE & PRICING

Date	Direction	Season	Date	Direction	Season
March 28, 2010	Dijon - Escommes	Value	July 25, 2010	Escommes - Dijon	Value
April 4, 2010	Escommes - Dijon	Value	August 1, 2010	Dijon - Escommes	Value
April 11, 2010	Dijon - Escommes	Value	August 8, 2010	Escommes - Dijon	Value
April 18, 2010	Escommes - Dijon	Value	August 15, 2010	Dijon - Escommes	Value
April 25, 2010	Dijon - Escommes	Value	August 22, 2010	Escommes - Dijon	Value
May 2, 2010	Escommes - Dijon	Value	August 29, 2010	Dijon - Escommes	Value
May 9, 2010	Dijon - Escommes	Value	September 5, 2010	Escommes - Dijon	Regular
May 16, 2010	Escommes - Dijon	Regular	September 12, 2010	Dijon - Escommes	Regular
May 23, 2010	Dijon - Escommes	Regular	September 19, 2010	Escommes - Dijon	Regular
May 30, 2010	Escommes - Dijon	Regular	September 26, 2010	Dijon - Escommes	Regular
June 6, 2010	Dijon - Escommes	Regular	October 3, 2010	Escommes - Dijon	Regular
June 13, 2010	Escommes - Dijon	Regular	October 10, 2010	Dijon - Escommes	Regular
June 20, 2010	Dijon - Escommes	Regular	October 17, 2010	Escommes - Dijon	Value
June 27, 2010	Escommes - Dijon	Regular	October 24, 2010	Dijon - Escommes	Value
July 4, 2010	Dijon - Escommes	Regular	October 31, 2010	Escommes - Dijon	Value
July 11, 2010	Escommes - Dijon	Regular	November 7, 2010	Dijon - Escommes	Value
July 18, 2010	Dijon - Escommes	Regular			

Individual Cabin Bookings	Value Weeks	Regular Weeks
Junior Suite Per Person	\$4,350	\$4,990
Suite Per Person	\$4,590	\$5,290
Single Supplement	\$1,700	\$1,900
Single Cabin	\$4,750	\$5,450
Full Boat Private Charter	Value Weeks	Regular Weeks
For 13 guests	\$50,800	\$59,000
For 12 guests	\$49,500	\$57,500
For 11 guests	\$48,200	\$56,000
For 10 guests	\$46,900	\$54,500