



FRANCE CRUISES



ETOILE

8 Passengers / Provence / Canal du Midi

Constructed in 1889 as a cargo barge

Last refit in 2008

Measures 112 ft. long by 16 ft. wide

Four (4) onboard cabin accommodations

Onboard climate control

L'Etoile spent most of her commercial life transporting cargo on the Rhine. Now, this classic Dutch barge has been converted to a passenger barge with today's standards of hotel barge comfort. The cozy barge atmosphere makes you feel immediately at home. **L'Etoile** English speaking French/Dutch owner - Cobie – and her crew are delightful, warm, friendly and knowledgeable hosts who welcome guests in Provence & Camargue.

PERSONNEL

Three (3) crew members consisting of Captain/Mechanic, Chef/Host/Owner, and Tour Guide/Matlot. This crew combined speaks English, French, Dutch, and German.

PUBLIC ROOMS

- **Salon/Dining Room**
- **Sun Deck**

ONBOARD LEISURE AND ENTERTAINMENT

Plunge pool • HI FI system with CD player & iPod docking station • Eclectic CD collection • 42" plasma TV with DVD player • Touring bikes • Fishing rods • Board games • Small library of books

MOBILITY RESTRICTIONS

Etoile has **no wheelchair access**. The boarding ramp has two (2) side handrails and there is a large, comfortably wide staircase with seven (7) stairs leading from the Deck to the Salon. From the Deck to the Sun Deck, there are two (2) steps. There are no steps from the Salon to the cabins.

DECK PLAN

Guests enjoy both a comfortable vessel and the talent of their hosts who will prepare outstanding meals and serves as capable guides throughout the surrounding region.

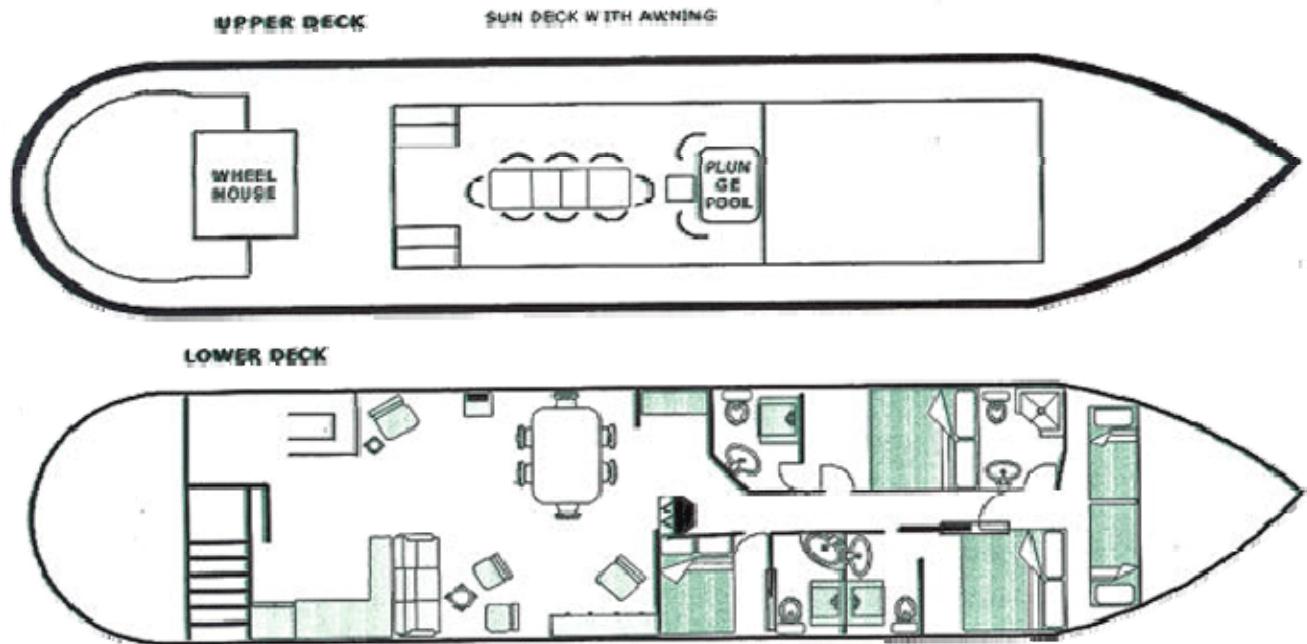

CABINS

Etoile has four (4) cabins that are uniquely decorated, light, and airy, each with opening skylight and portholes. Their lavish bedding is indicative of the opulent charm that surrounds the entire vessel. Ample storage is available in each cabin as well as air-conditioning and fully private en suite bathroom facilities. The cabins are distinguished as follows:

- **Chambre Rouge**
- **Chambre Bleu**
- **Chambre Provencal**
- **Studio Cabin**

Guests staying in **La Chambre Rouge** and **Bleu** enjoy the added amenity of an overhead skylight.

CABIN SIZE

While all cabins are designed and decorated to maximize space, each cabin does vary considerably in size. The sizes listed below include bathroom area:

- **Chambre Rouge** - Approx. 116 sq. ft.
- **Chambre Bleu** - Approx. 92 sq. ft.
- **Chambre Provencal** - Approx. 88 sq. ft.
- **Studio Cabin** - Approx. 86sq. ft.

BEDDING CONFIGURATION & SIZE

Each cabin has a fixed bedding configuration which is important to note prior to booking. The configuration is outlined below:

- **Chambre Rouge** - King (Bed size: 6' 11" X 6')
- **Chambre Bleu** - King (Bed size: 6' 11" X 6')
- **Chambre Provencal** - Double (Bed size: 6' 7" X 5')
- **Studio Cabin** - Twin (Bed size: 6' 11" X 2' 4")



The twin configuration of the **Studio Cabin** features two (2) twin beds placed toe-to-toe with minimal space between each.

BATHROOMS

Each cabin has a fully private en suite bathroom well-stocked with towels and bath products. **Etoile** also provides hairdryers for its guests.

AMENITIES

Climate Control • Hairdryer • Storage Space • Alarm Clock • Bottled Water • Wooden Hangers • Make-Up Mirror and Full-Length Mirror • Electricity (220V, French two pin plugs) • Small Flashlight

SALON/DINING ROOM

The large **Salon/Dining Room** has plenty of natural light and is decorated in a contemporary French style. While enjoying comfortable and cozy furniture, guests are more than welcome to watch satellite TV on the 42" plasma TV, connect their iPod via docking station to the stereo system, or help themselves to a movie from the video/DVD collection. There is central heating throughout this public forum and a marble open fireplace which gives remarkable ambiance to the cooler spring and autumn cruises. The **Salon/Dining Room** furniture includes:

- Sofa
- 4 Armchairs
- Small desk
- Coffee tables
- Wine bureau
- Well-stocked bar
- Dining table with seating for eight (8) people



ON DECK

The **Sun Deck** is a spacious 308 sq. ft. open-air gathering area with plenty of seating for those who wish to soak up the sun. Should the weather be too warm, there is an invigorating plunge pool, six (6) lounge chairs, and a canopy to provide abundant shade. An "al fresco" dining table makes for memorable outdoor meals any time of the day or evening.

OFF BOAT

Passengers are welcome to walk or cycle using the onboard bicycles as often as they like. Most people choose to disembark the barge at a lock to visit local villages, then return to the canal and meet the barge further along (the barge travels slowly; therefore, this is not a problem). An air-conditioned Mercedes van is also available for transfers and shore excursions.

ITINERARY

Etoile tours through beautiful Provence & Camargue. It is a very scenic cruise along the Mediterranean coast, where the Canal runs along the lagoons, beaches and seaside resorts, all the way to the door of the hill country of Provence.

Itinerary Highlights:

Provence & Camargue: Visit of Pont du Gard, Avignon - Pope's Palace, les Baux de Provence - Saint Rémy de Provence, Arles and its Amphitheatre, walled city of Aigues Mortes, Maguelone Abbey Church. Meeting point in Avignon or Montpellier

FOOD & WINE

Start each day with an assortment of fresh breads, croissants and sweet rolls purchased from the nearby 'boulangerie'. Coffee, tea, fruit juice, hot chocolate, local butter and homemade jam, yoghurt and cereals are always offered. Lunches are served buffet style and are accompanied by selected local red, white and rosé wines. A typical menu might include a homemade soup, a mixed green salad with walnuts & Roquefort, a quiche... 'Charcuterie' is also included and could consist of smoked ham, sliced duck, or pâté and of course, a selection of cheeses. The open kitchen allows you to watch your chef work, to share recipes or if you wish, to participate!

2010 SCHEDULE & PRICING

Date	Direction	Date	Direction
March 28, 2010	Avignon-Aigues-Mortes	July 25, 2010	Aigues-Mortes-Avignon
April 4, 2010	Aigues-Mortes-Avignon	August 1, 2010	Avignon-Aigues-Mortes
April 11, 2010	Avignon-Aigues-Mortes	August 8, 2010	Aigues-Mortes-Avignon
April 18, 2010	Aigues-Mortes-Avignon	August 15, 2010	Avignon-Aigues-Mortes
April 25, 2010	Avignon-Aigues-Mortes	August 22, 2010	Aigues-Mortes-Avignon
May 2, 2010	Aigues-Mortes-Avignon	August 29, 2010	Avignon-Aigues-Mortes
May 9, 2010	Avignon-Aigues-Mortes	September 5, 2010	Aigues-Mortes-Avignon
May 16, 2010	Aigues-Mortes-Avignon	September 12, 2010	Avignon-Aigues-Mortes
May 23, 2010	Avignon-Aigues-Mortes	September 19, 2010	Aigues-Mortes-Avignon
May 30, 2010	Aigues-Mortes-Avignon	September 26, 2010	Avignon-Aigues-Mortes
June 6, 2010	Avignon-Aigues-Mortes	October 3, 2010	Aigues-Mortes-Avignon
June 13, 2010	Aigues-Mortes-Avignon	October 10, 2010	Avignon-Aigues-Mortes
June 20, 2010	Avignon-Aigues-Mortes	October 17, 2010	Aigues-Mortes-Avignon
June 27, 2010	Aigues-Mortes-Avignon	October 24, 2010	Avignon-Aigues-Mortes
July 4, 2010	Avignon-Aigues-Mortes	October 31, 2010	Aigues-Mortes-Avignon
July 11, 2010	Aigues-Mortes-Avignon	November 7, 2010	Avignon-Aigues-Mortes
July 18, 2010	Avignon-Aigues-Mortes		

Individual Cabin Bookings	7 Days / 6 Nights (Full Board) Sunday - Saturday	
Per Person (2 sharing)	<ul style="list-style-type: none"> • \$3,800 (Suite) • \$3,400 (Junior Suite) • \$2,950 (Twin Cabin) 	
Full Boat Private Charter	Full Board	Half Board
For 8 guests	\$25,000	\$23,000
For 7 guests	\$23,000	\$21,000
For 6 guests	\$21,000	\$19,000
For 5 guests	\$20,000	\$17,500
For 4 guests	\$18,000	\$16,000