



## **EMMA**

*6 Passengers / Canal du Midi*

Constructed in 1906  
Converted into a hotel barge in 2001  
Measures 94 ft. long by 16 ft. wide  
Three (3) onboard cabin accommodations  
Onboard climate control

**Emma** is a lovingly restored barge of 28 meters in length and 4.6 meters wide – a Klipper Aak of Belgian origin. She lived in the Paris region for her first 95 years until she was lured south with the promise of sun and a luxury fit out in 2001. Today **Emma** is welcoming her guests with great accommodation and service, gourmet cuisine and a warm atmosphere that will make your trip unforgettable.

## **PERSONNEL**

Four (4) crew members consisting of Tour Guide, Chef, Hostess, and Captain. A mixture of Irish and French origin, this crew speaks both English and French (some may speak other languages, as well).

## **PUBLIC ROOMS**

- **Salon/Dining Room**
- **Sun Deck**

## **ONBOARD LEISURE AND ENTERTAINMENT**

Stereo system with CD player • TV with DVD player • Six (6) touring bikes • Small library of books

## **MOBILITY RESTRICTIONS**

Emma has **no wheelchair access**. There are narrow steps leading down from the deck to the salon area which may be difficult to navigate for people with very limited mobility.

## **DECK PLAN**

The well-planned accommodation of Emma offers a choice of three air-conditioned twin/double staterooms with full en-suite facilities.

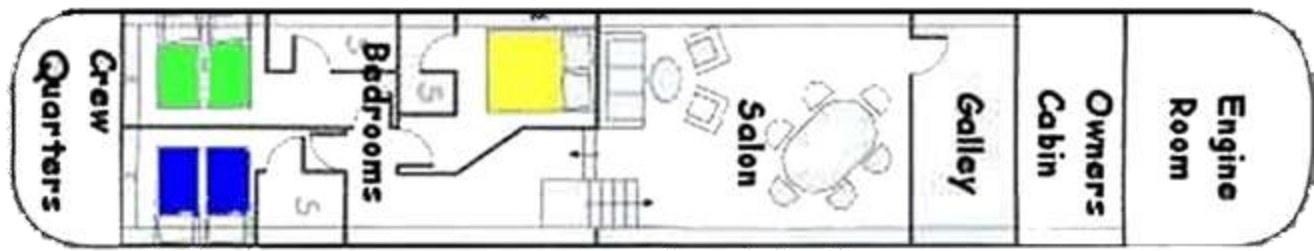

## CABINS

There are three (3) cabins on board **Emma**, named **Mimosa**, **Muguet**, and **Lavande**. Handmade Irish patchwork quilts by Oonagh Morisson add that extra touch of luxury. The cabins are further color-coded in the following way based on accompanying room decorations:

- **Mimosa** - Gold cabin
- **Muguet** - Green cabin
- **Lavande** - Lavender cabin

## CABIN SIZE

All cabins are very similar in size and are equally comfortable measuring approximately 100 sq. ft. each.

## BEDDING CONFIGURATION & SIZE

**Muguet** and **Lavande** come with the choice of two (2) single beds, or one (1) double bed, while **Mimosa** has a fixed double bed. When the cabins are in twin bed configuration, the beds are parallel with a gap between them.

## BATHROOMS

Each cabin has its own bathroom with wash hand basin, toilet, and a normal-sized shower with sliding doors. The bathrooms are beautifully tiled, each one being a different color to complement the color of the cabin. Towels, bathrobes, hairdryers, and French toiletries by L'Occitane are also provided.



## AMENITIES

Climate Control • Hairdryer • Electricity (220V, French two pin plugs)

## SALON/DINING ROOM

The interior is bright and spacious with beautiful arched double glazed windows which provide a good view of the exterior countryside while cruising. The French oak furniture has been hand made by a master craftsman and the whole effect is warm and inviting. The boat is fully air-conditioned and centrally heated to meet all climatic conditions. Some furniture items include:

- Dining table with seating for six (6) people
- Armchairs
- Coffee table
- Well-stocked bar

Guests are welcome to peruse the books in the library, listen to the varied selection of CD's, help themselves to the well-stocked bar, and generally make themselves thoroughly at home.

## ON DECK

The outer deck is where guests can relax and breathe in the wonderful smells of pine, broom, thyme, and rosemary as they watch the countryside glide past. There is ample space for lounging and a lovely area for cocktail hour and "al fresco" eating. **Emma** also has her own flower and herb garden which Liz rifles on a daily basis for use in the kitchen.



## OFF BOAT

Passengers are welcome to walk or cycle using the onboard bicycles as often as they like. Most People choose to disembark the barge at a lock to visit local villages, then return to the canal and meet the barge further along (the barge travels slowly; therefore, this is not a problem). Additionally, an air-conditioned minibus is available for excursions by vehicle.

## ITINERARY

A cruise on **Emma** is a step back from the pressure of the 21st century to a much slower pace, while enjoying all the creature comforts of modern day living. You can visit ancient villages where time appears to stand still, country chateaux where you can taste the wine grown in their own vineyards, shop at the local markets where you will be amazed by the colorful displays of fresh fruit and

vegetables, you can cycle along the towpath if you are feeling energetic or you can just relax on board and watch the world glide by. Every day is a different picture. **Emma** will slowly wind her way during the course of the week for approximately 80 kilometers (50 miles) along the canal which was built during the reign of Louis XIV.

### Itinerary Highlights:

The vast medieval castle of **Carcassonne**

The roman town of **Narbonne**

The former Cathar stronghold at **Minerve**

The magnificent **Fonserannes** 7-lock staircase

The fortified hilltop city of **Oppidum d'Enserune** overlooking the Languedoc Valley

## FOOD & WINE

Cuisine on board **Emma** is French and made using the freshest ingredients the region has to offer.

## 2010 SCHEDULE & PRICING

Date	Direction	Date	Direction
April 3, 2010	Beziers - Carcassonne	July 24, 2010	Beziers - Carcassonne
April 10, 2010	Carcassonne - Beziers	July 31, 2010	Carcassonne - Beziers
April 17, 2010	Beziers - Carcassonne	August 7, 2010	Beziers - Carcassonne
April 24, 2010	Carcassonne - Beziers	August 14, 2010	Carcassonne - Beziers
May 1, 2010	Beziers - Carcassonne	August 21, 2010	Beziers - Carcassonne
May 8, 2010	Carcassonne - Beziers	August 28, 2010	Carcassonne - Beziers
May 15, 2010	Beziers - Carcassonne	September 4, 2010	Beziers - Carcassonne
May 22, 2010	Carcassonne - Beziers	September 11, 2010	Carcassonne - Beziers
May 29, 2010	Beziers - Carcassonne	September 18, 2010	Beziers - Carcassonne
June 5, 2010	Carcassonne - Beziers	September 25, 2010	Carcassonne - Beziers
June 12, 2010	Beziers - Carcassonne	October 2, 2010	Beziers - Carcassonne
June 19, 2010	Carcassonne - Beziers	October 9, 2010	Carcassonne - Beziers
June 26, 2010	Beziers - Carcassonne	October 16, 2010	Beziers - Carcassonne
July 3, 2010	Carcassonne - Beziers	October 23, 2010	Carcassonne - Beziers
July 10, 2010	Beziers - Carcassonne	October 30, 2010	Beziers - Carcassonne
July 17, 2010	Carcassonne - Beziers		

Individual Cabin Bookings	Full Board	Half Board
Per Person (2 sharing)	\$4,500	N/A
Single Supplement	\$1,500	N/A
Full Boat Private Charter	Full Board	Half Board
For 6 guests	\$24,000	\$22,000
For 5 guests	\$23,000	\$21,000
For 4 guests	\$22,000	\$20,000